

Knurling Tool Holder

Index Plate Type

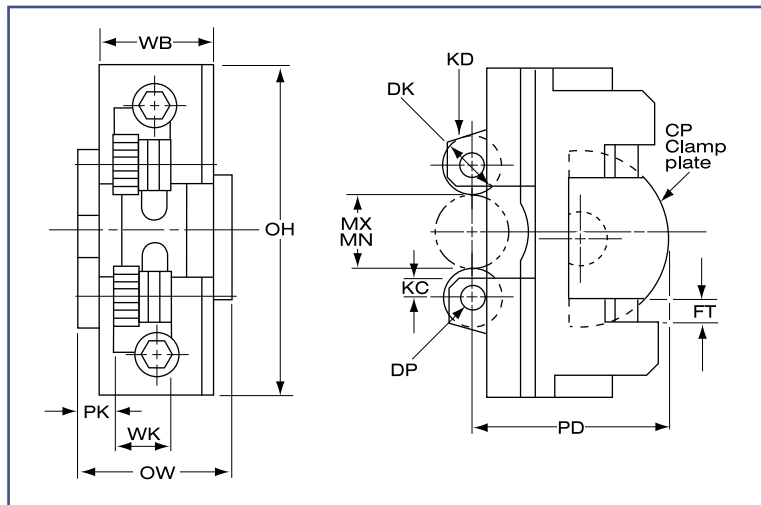

Order Number		KTC-7210
(MX)	Max. Capacity	7/8
(MN)	Min. Capacity	1/8
(OH)	Overall Height	3-3/4
(OW)	Overall Width	1-3/4
(CP)	Clamp Plate Dia.	2.00
(WB)	Width of Body	1-1/4
(WK)	Max. Width of Knurl	5/8
(DK)	Max. Dia. of Knurl	7/8
(KD)	Max. Knurl Dia. w/Max. Stock	3/4
(KC)	Knurl Clearance	7/32
(DP)	Dia. Pin in Knurl	1/4
(PK)	Dist. from Plate to Knurl	13/32
(PD)	Distance to Plate	2-1/4
(FT)	Float Travel	5/32

Cross-slide knurling toolholders are used to make straight, spiral or diamond knurls. Knurl rolls not furnished with holder.



Knurling Tool Holder

Shank Type

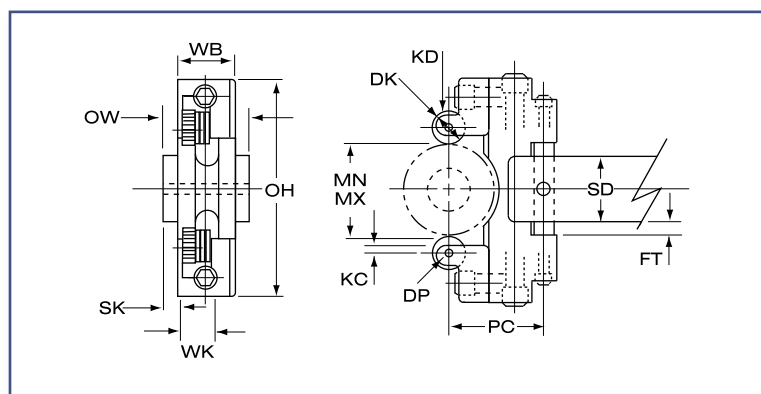

Order Number		KTC-7410
(MX)	Max. Capacity	7/8
(MN)	Min. Capacity	1/8
(OH)	Overall Height	3-3/4
(OW)	Overall Width	1-3/4
(SD)	Shank Diameter	1
(WB)	Width of Body	1-1/4
(WK)	Max. Width of Knurl	5/8
(DK)	Max. Dia. of Knurl	7/8
(KD)	Max. Knurl Dia. w/Max. Stock	3/4
(KC)	Knurl Clearance	7/32
(DP)	Dia. Pin in Knurl	1/4
(SK)	Dist. from Shank to Knurl	13/32
(PC)	Distance to Pin CL	1-13/16
(FT)	Float Travel	5/32

Cross-slide knurling toolholders are used to make straight, spiral or diamond knurls. Knurl rolls not furnished with holder.